

DATA SHEET

**DVT 3.100**

# ROTARY VANE PRESSURE/VACUUM PUMPS

oil-free

air-cooled

---

**MAKE IT BECKER.**



figure DVT 3.80

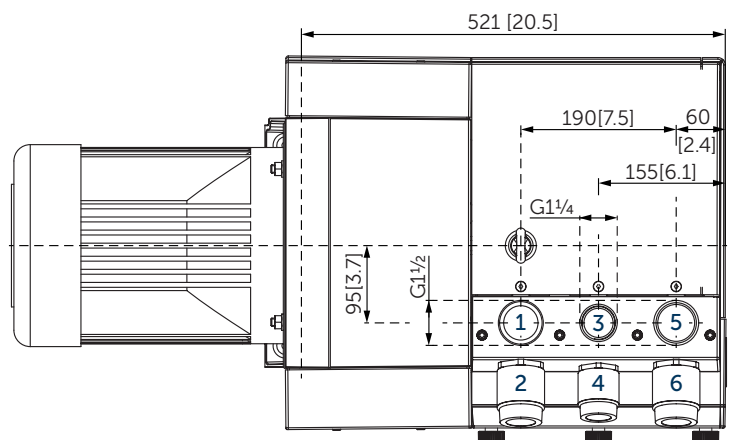
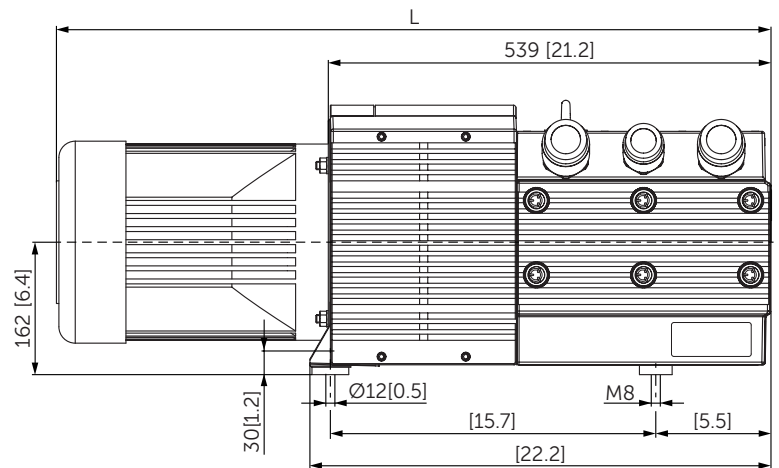
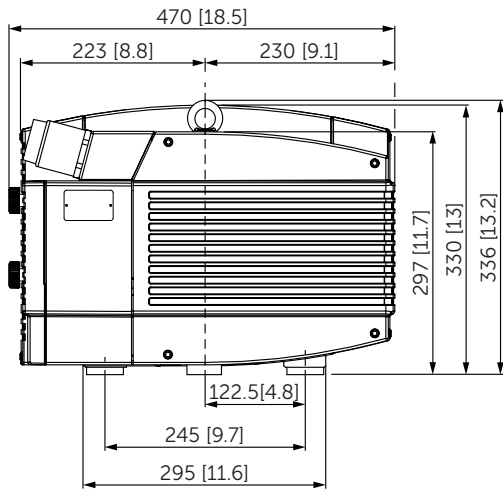

- 1 Pressure connection (G1½)
- 2 Pressure regulating valve
- 3 Option: second suction (G¼)
- 4 Option: vacuum regulating valve for second suction
- 5 Vacuum connection (G1½)
- 6 Vacuum regulating valve
  - Including integrated suction air filter
  - The motor illustration may vary.
  - Dimensions in mm [inch]

| Air rate          |       | Pressure/vacuum relative |       | Motors |       | Emission sound pressure level <sup>1)</sup> |       | Weight w/o motor |
|-------------------|-------|--------------------------|-------|--------|-------|---|-------|------------------|
| m <sup>3</sup> /h |       | bar                      |       | kW     |       | dB(A)                                       |       | kg               |
| 50 Hz             | 60 Hz | 50 Hz                    | 60 Hz | 50 Hz  | 60 Hz | 50 Hz                                       | 60 Hz |                  |
| 103               | 120   | ±0.5                     | ±0.5  | 5.5    | 6.6   | 76-77                                       | 77-78 | 71               |
| 103               | 120   | ±0.6                     | ±0.6  | 5.5    | 6.6   | 76-77                                       | 77-78 | 71               |

<sup>1)</sup> According to DIN EN ISO 3744 (KpA = 3 dB(A)), 1 m [39.4 inch] distance, at medium load, both connection sides piped

| 3~ Motors |       |           |                   |      |           |     |                   |     |         |                |   | L    |               |
|-----------|-------|-----------|-------------------|------|-----------|-----|-------------------|-----|---------|----------------|---|------|---------------|
| #         | 50 Hz |           |                   |      | 60 Hz     |     |                   |     | Version | Weight<br>kg   | mm<br>[inch]  |      |               |
|           | kW    | V         | min <sup>-1</sup> | A    | kW        | V   | min <sup>-1</sup> | A   |         |                |   |      |               |
| 01        | 5,5   | Δ400      | IE3               | 1470 | 12,3      | 6,6 | Δ460              | IE3 | 1765    | 12,0           | IP55 • ISO F • bimetal                                | 53,0 | 913<br>[36,0] |
|           |       |           |                   |      |           |     | Δ400              |     |         | 1751           |   |      |               |
| 02        |       |           |                   |      |           | 6,6 | YY230/Y460        | IE3 | 1768    | 23,9/11,95     | UL(E365362) • CSA<br>IP55 • ISO F • bimetal           | 63,5 | 951<br>[37,5] |
|           |       |           |                   |      |           |     | YY208             |     |         | 1760           |   |      |               |
| 03        | 5,5   | Δ200/Y350 | IE3               | 1465 | 21,5/12,4 | 6,6 | Δ220/Y380-400     | IE3 | 1755    | 22,5/13,2-12,7 | UL(E365362) • CSA<br>CC334B<br>IP55 • ISO F • bimetal | 63,5 | 951<br>[37,5] |
|           |       |           |                   |      |           |     | Δ200/Y350         |     |         | 1740           |   |      |               |
| 04        |       |           |                   |      |           | 6,6 | Δ400/Y690         | IE3 | 1760    | 12,5/7,2       | UL(E365362) • CSA<br>CC334B<br>IP55 • ISO F • bimetal | 63,5 | 951<br>[37,5] |

- Current consumption and rotation speed may vary. Tolerance in each case -1.5/+2%

| Air rates • power consumptions • temperatures |                            |                   |                 |          |          |          |       |          |          |          |
|---|----------------------------|-------------------|-----------------|----------|----------|----------|-------|----------|----------|----------|
| relative pressure                             |                            |                   | relative vacuum |          |          |          |       |          |          |          |
|   |                            |                   | 50 Hz           |          |          |          | 60 Hz |          |          |          |
|   |                            |                   | 0 bar           | -0.4 bar | -0.5 bar | -0.6 bar | 0 bar | -0.4 bar | -0.5 bar | -0.6 bar |
| +0.4 bar                                      | Suction air rate           | m <sup>3</sup> /h | 95.7            | 51.0     | 40.5     | 29.8     | 112.6 | 62.1     | 49.9     | 37.7     |
|   | Blast air rate             | m <sup>3</sup> /h | 98.2            | 74.6     | 67.1     | 58.7     | 117.6 | 87.6     | 77.9     | 67.7     |
|   | Power consumption          | kW                | 3.16            | 3.88     | 3.99     | 4.10     | 4.44  | 5.00     | 5.04     | 5.11     |
|   | Temperature compressed air | °C                | 38              | 42       | 42       | 43       | 41    | 45       | 45       | 45       |
| +0.5 bar                                      | Suction air rate           | m <sup>3</sup> /h | 95.6            | 51.0     | 40.2     | 29.7     | 113.7 | 62.6     | 50.0     | 37.6     |
|   | Blast air rate             | m <sup>3</sup> /h | 98.0            | 74.7     | 66.9     | 58.8     | 119   | 88.3     | 78.2     | 67.8     |
|   | Power consumption          | kW                | 3.28            | 4.01     | 4.11     | 4.22     | 4.51  | 5.14     | 5.20     | 5.28     |
|   | Temperature compressed air | °C                | 39              | 43       | 44       | 44       | 43    | 46       | 46       | 46       |
| +0.6 bar                                      | Suction air rate           | m <sup>3</sup> /h | 96.1            | 50.2     | 39.9     | 29.9     | 112.7 | 61.9     | 49.3     | 37.6     |
|   | Blast air rate             | m <sup>3</sup> /h | 98.5            | 73.7     | 66.6     | 58.8     | 117.8 | 87.7     | 77.7     | 67.9     |
|   | Power consumption          | kW                | 3.43            | 4.17     | 4.27     | 4.37     | 4.66  | 5.29     | 5.37     | 5.44     |
|   | Temperature compressed air | °C                | 40              | 44       | 45       | 45       | 43    | 46       | 46       | 46       |

Reference data (atmosphere): 1000 mbar (100 kPa), 20°C (68°F)

Tolerance: ±5%

Air temperature: 5°C ... 45°C (41°F ... 135°F)

## **+** VARIANTS AND ACCESSORIES

- With first and second suction
- With external suction filter<sup>1)</sup>
- Sound proof box SH 13<sup>1)</sup>



Example for an external suction filter



Sound proof box SH 13

<sup>1)</sup> See separate data sheet

- Possible combinations on request



**MAKE IT BECKER.**